

INTRODUCING



WOLVERHAMPTON

SPACES Wolverhampton  
i11 Building  
4-5 Victoria square  
Wolverhampton  
WV1 1ld

07535 401451

# INTRODUCING SPACES WOLVERHAMPTON

## Welcome to SPACES

- Located in the emerging commerce area of wolverhampton
- Brand new facility offering the best of hybrid working
- Flexible fully customisable office rentals by the hour, day or as long as you need
- Excellent transport links



# INTRODUCING SPACES WOLVERHAMPTON

## Overview

- In the Victoria Square facility next to the city's £150 million transport interchange with i9 and i10
- 10,000 sqft first floor – serviced offices and workspaces for 250 people





# INTRODUCING SPACES WOLVERHAMPTON

## i11 Building

- Wolverhampton train station
- Tram link to Birmingham
- Bus station
- Emerging commercial district of Wolverhampton
- Local shopping centre
- Local parking facilities
- Networking with i9 and i10



# INTRODUCING SPACES WOLVERHAMPTON

# Floor Plan

- 39 offices all on 1 level
- Communal facilities
- Large co-working office
- Refreshments available
- Disability access and facilities





# INTRODUCING SPACES WOLVERHAMPTON

## Communal Facilities

- 2 meeting rooms  
mr1 = 6 PEOPLE mr 2 = 8 PEOPLE
- Open plan business lounge
- Reception area

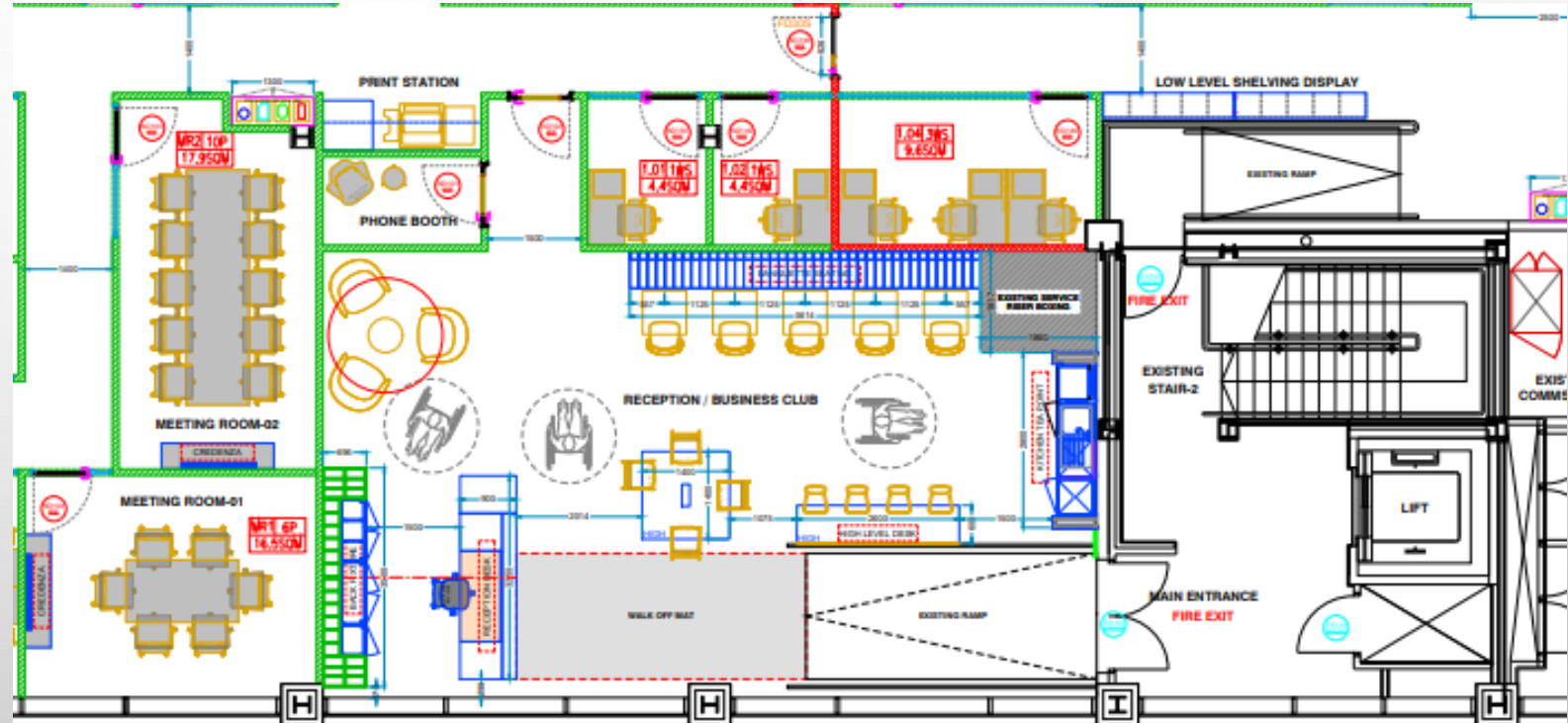

# INTRODUCING SPACES WOLVERHAMPTON

## Communal Facilities

- Phone booth
- Lift
- Refreshments available
- Disability access and facilities

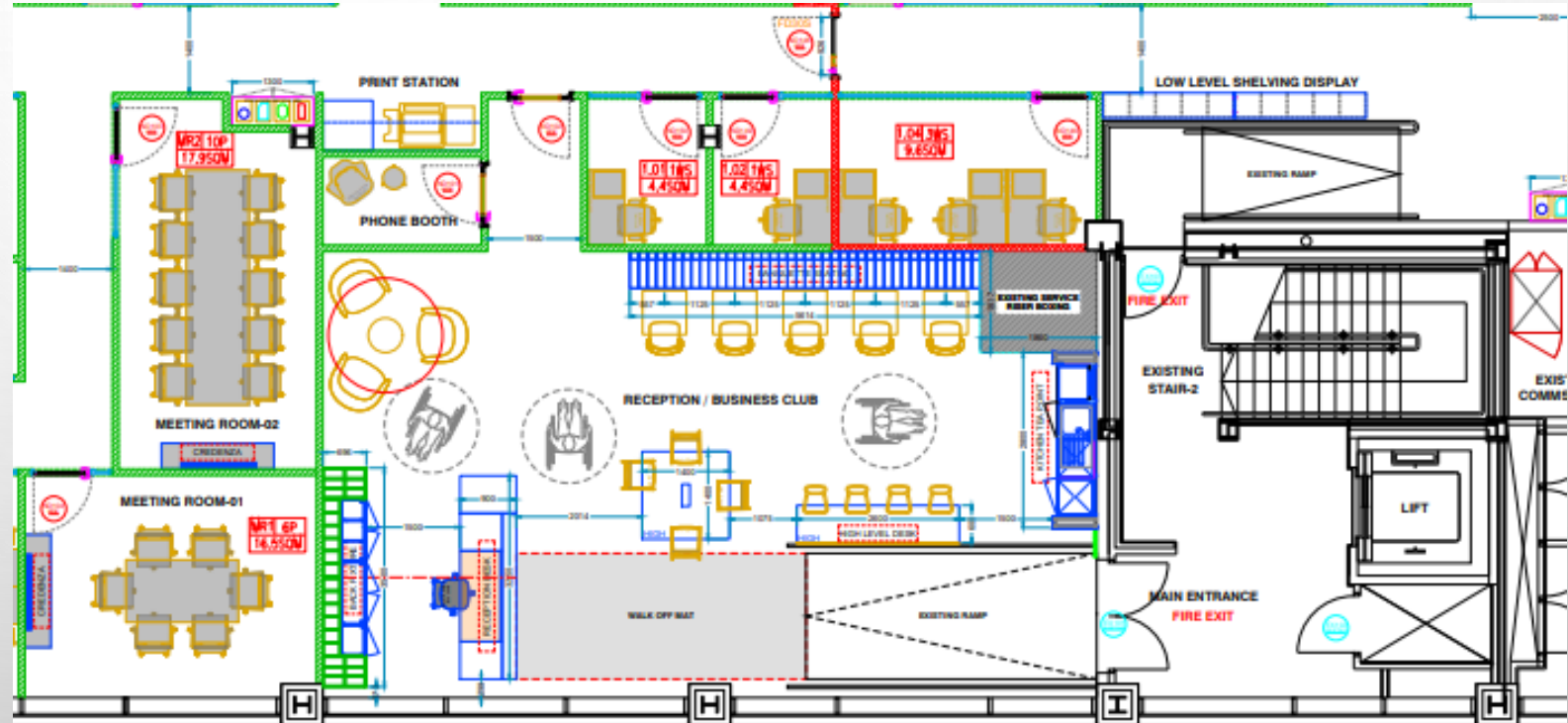

# INTRODUCING SPACES WOLVERHAMPTON

## IWG Feature Benefits

In more than 3,400 locations, you will find everything you need to enhance productivity – not just offices, co-working, meeting rooms and virtual offices, but also essential amenities and useful support services.

It is the widest choice of locations, enabling you to go wherever business takes you quickly and easily.





# INTRODUCING SPACES WOLVERHAMPTON





# INTRODUCING SPACES WOLVERHAMPTON



- Wolverhampton train station
- Tram link to Birmingham
- Bus station